

NOTE: This home may require wall bracing tie-downs depending on wind/seismic design. Please refer to the permit set for tie-downs and locations if applicable. Some areas of the exterior wall sheathing may be shipped loose to allow access for tie-down installation. All tie-down designs are by others.

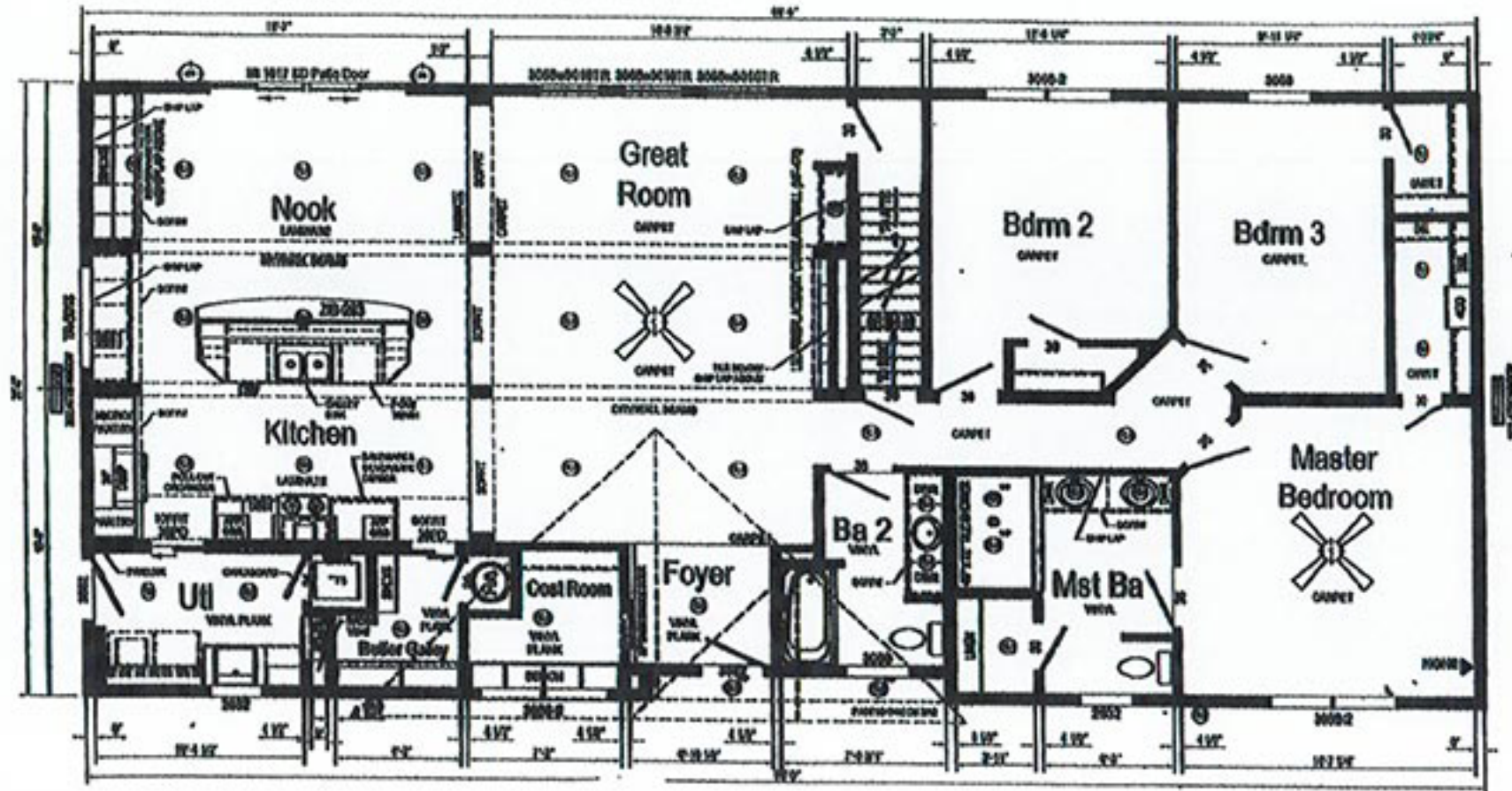

HE304-A44 3168 Approx. 2089 Sq. Ft.

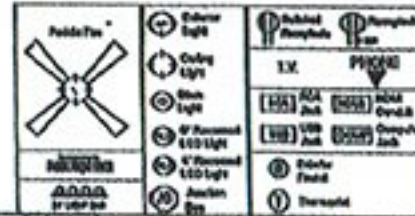

Stairway:
Riser HT: 8 1/4\"/>

By: Pennwest Homes
Title: Literature

Calcut	3168	Revisions			
Case		Case Number			
Date	11/15/2018	Drawn By	KM	Scale	1/8" = 1'-0"
Date	11/15/2018	Revisions	NONE	Drawn By	KM

Cost	Stock
OK: Schalls Modern Homes	OK: Schalls Modern Homes
GN:	GN:

Modeling No:
HE304-A44
Pg: 1/1













